



# DUTCH NATIONAL OPERA &

# FLOOR PLAN

## -1

### ODEONZAAL

A surprise underneath the theatre! A space for an introduction, presentation, dinner or party.

## 0

### GROUND FLOOR

A convenient and spacious entrance hall. Plenty of opportunity for registration, branding and providing information.

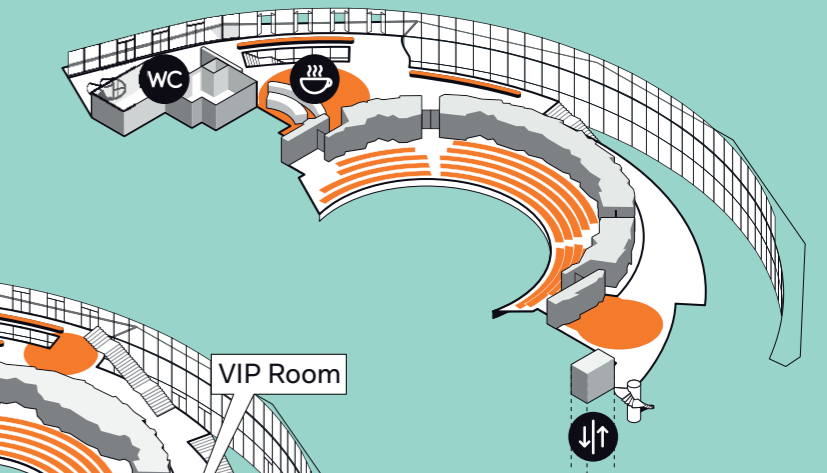

## 3

### 2<sup>ND</sup> BALCONY

The highest of the theatre foyers. How far along the River Amstel can you see?

## 2

### 1<sup>ST</sup> BALCONY

Access to the VIP room and the entresol. An unforgettable view – both day and night.

## 1

### STALLS

1300 m<sup>2</sup> of creative floor space, 14m-high ceilings and three fitted bars for your event.

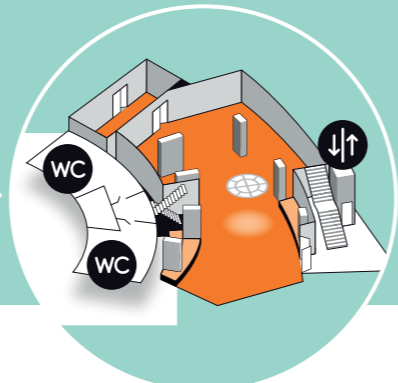
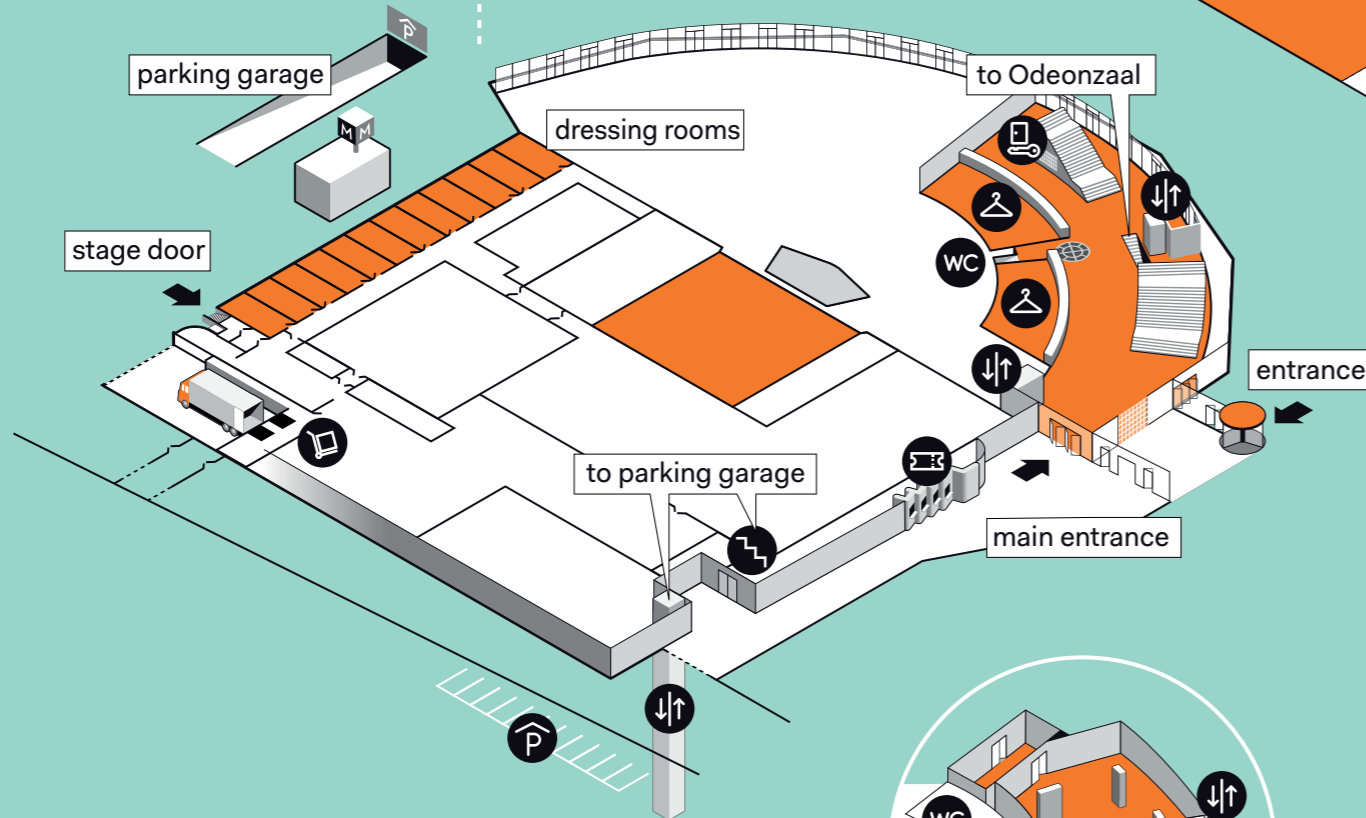

The foyers and the entresol offer a magnificent view of the River Amstel, the Blue Bridge, the Skinny Bridge and the imposing canalside façades.